

# Jøtul F 205 V2

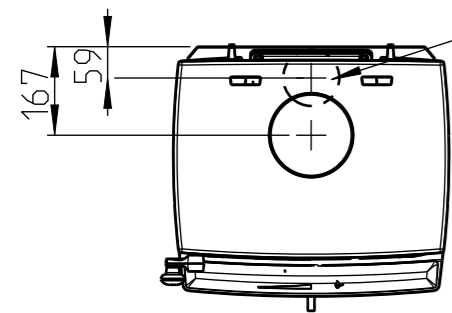

Hole in the floor for external air Ø80

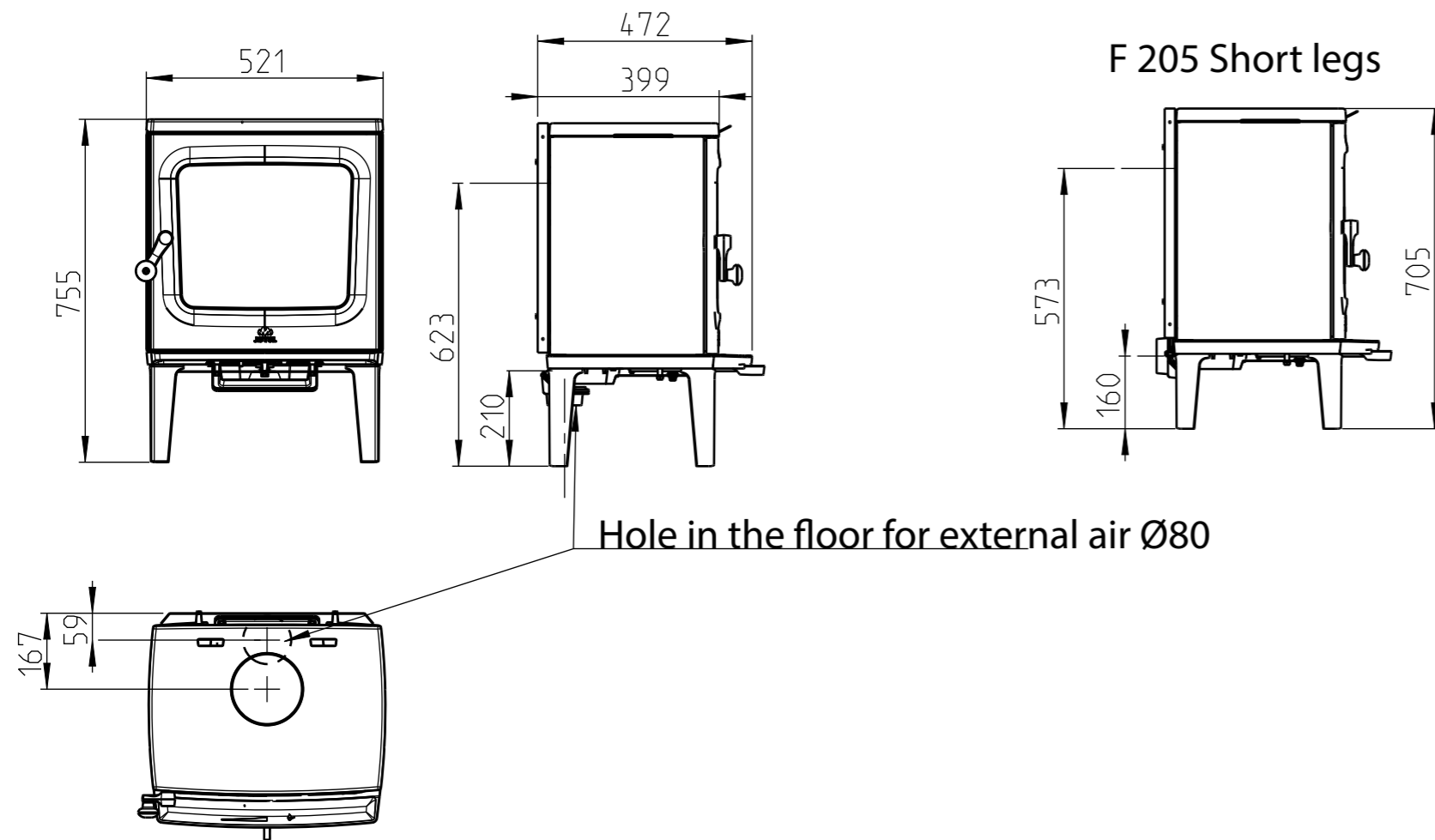
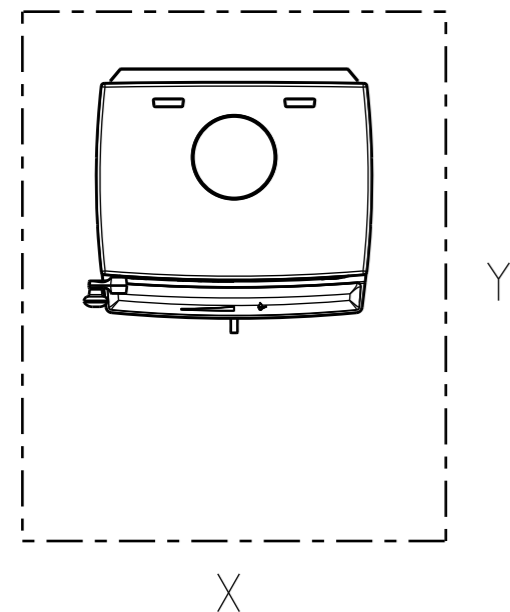

Min. measurments floor plate  
X/Y = According to national laws and regulations

Min. distance to ceiling and furniture

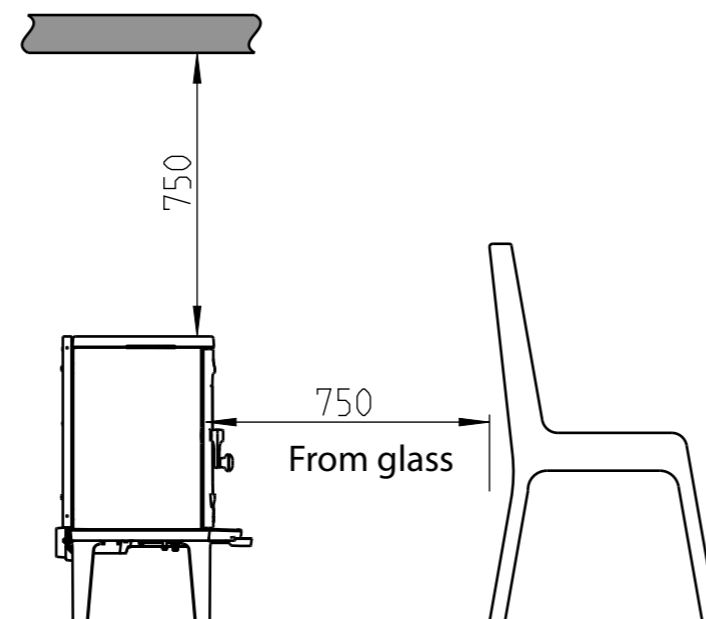

Min. distance to combustible wall

Semi-isolated flue pipe (minimum 25 mm insulation) all the way down towards the product.

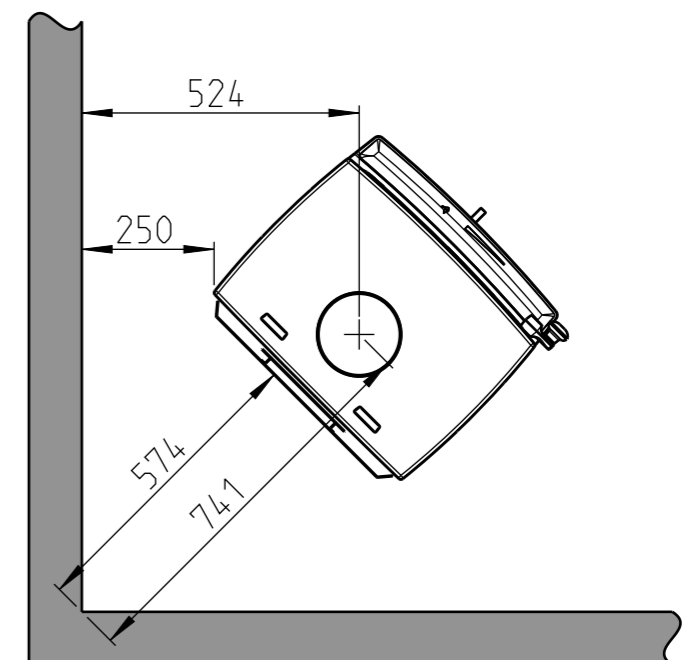
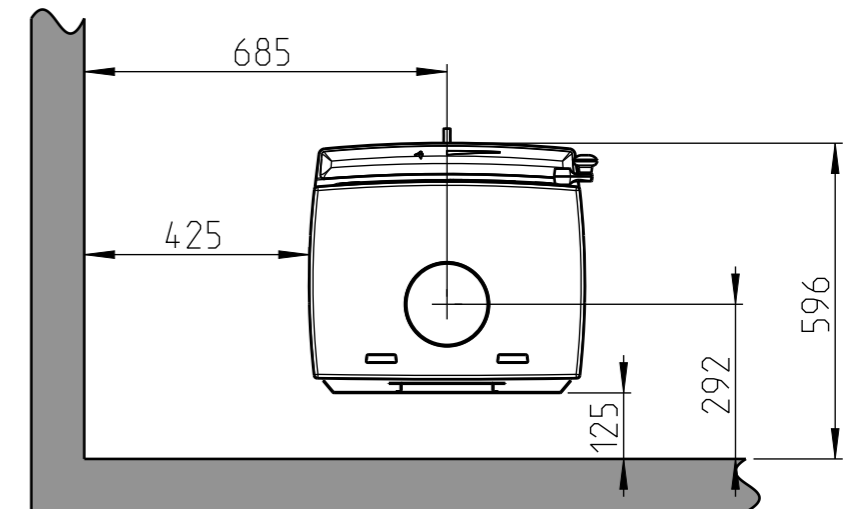

Combustible wall

Firewall (See chapter 3 in the manual)

# Jøtul F 205 V2

Min. distance to combustible wall protected by approved firewall

